

SEE DETAIL A-A

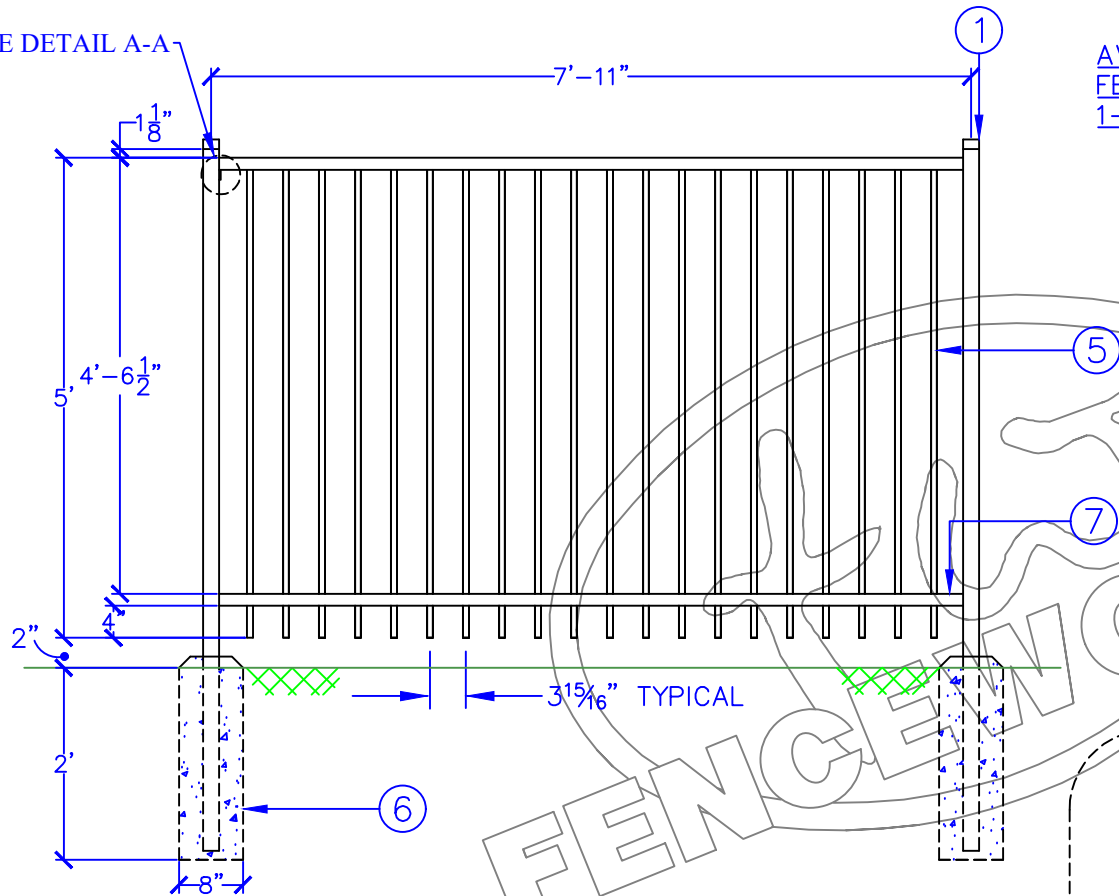

AVAILABLE THROUGH
 FENCEWORKS INC.
 1-800-788-5620

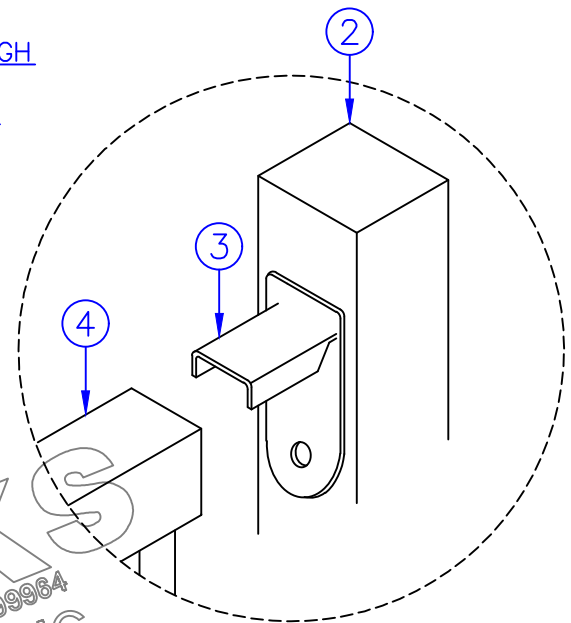

BRACKET ATTACHMENT DETAIL

LEGEND

1. 2" SQ. GA. POST W/ CAP
2. 2" X 2" FENCE POST
3. OUTSIDE DIAMETER SLIGHTLY LESS THAN INSIDE DIAMETER OF TOP OR BOTTOM RAIL.
4. FENCE RAIL SLIPS OVER POST ASSEMBLY
5. 3/4" SQ. PICKETS @ 4-1/2" O.C. (19 GA.)
6. FORERUNNER RAILS 1 1/2" X 1 1/2" X 16GA.
7. 8" X 24" DOMED CONCRETE FOOTING

"NO MAR" POLYESTER
 POWDER COATING

ZINC PHOSPHATE &
 CONVERSION COATING

"POWDER-GALV
 UNIFORM ZINC COATING
 (HOT DIP GALVANIZED)

BASE MATERIAL

"POWDER-GALV
 UNIFORM ZINC COATING
 (HOT DIP GALVANIZED)

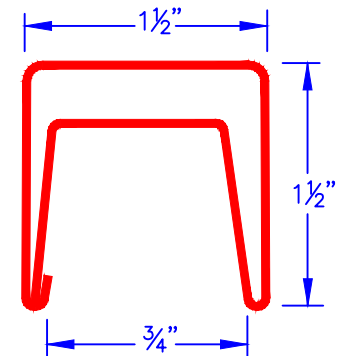

RAIL DETAIL

SCALE: NTS UNLESS NOTED

DETAIL NO.

0/1-003

LICENSE NO.

299964

FW-3/4" AEGIS PLUS PANEL

WEBSITE

WWW.FENCEWORKS.US

PHONE NO.

(800) 350-5620

LOCATION:
 ANAHEIM
 RIVERSIDE
 FRESNO
 PALMDALE
 MANTECA
 SACRAMENTO
 BAKERSFIELD
 SANTA PAULA
 FALLBROOK

