

AVAILABLE THROUGH
 FENCEWORKS INC.
 1-800-788-5620

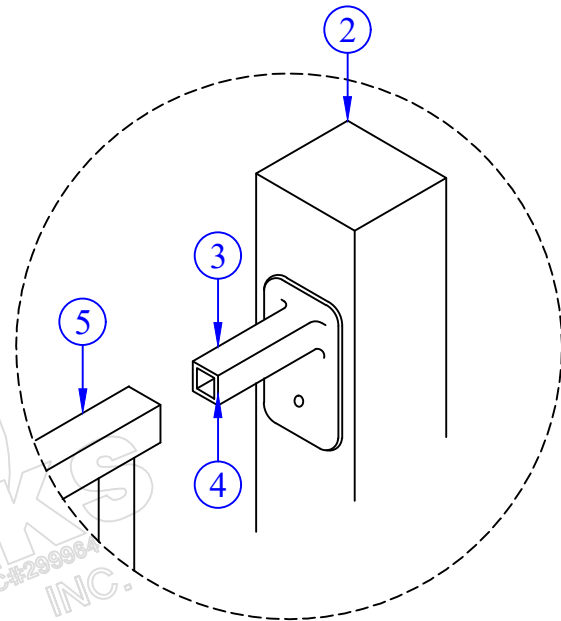
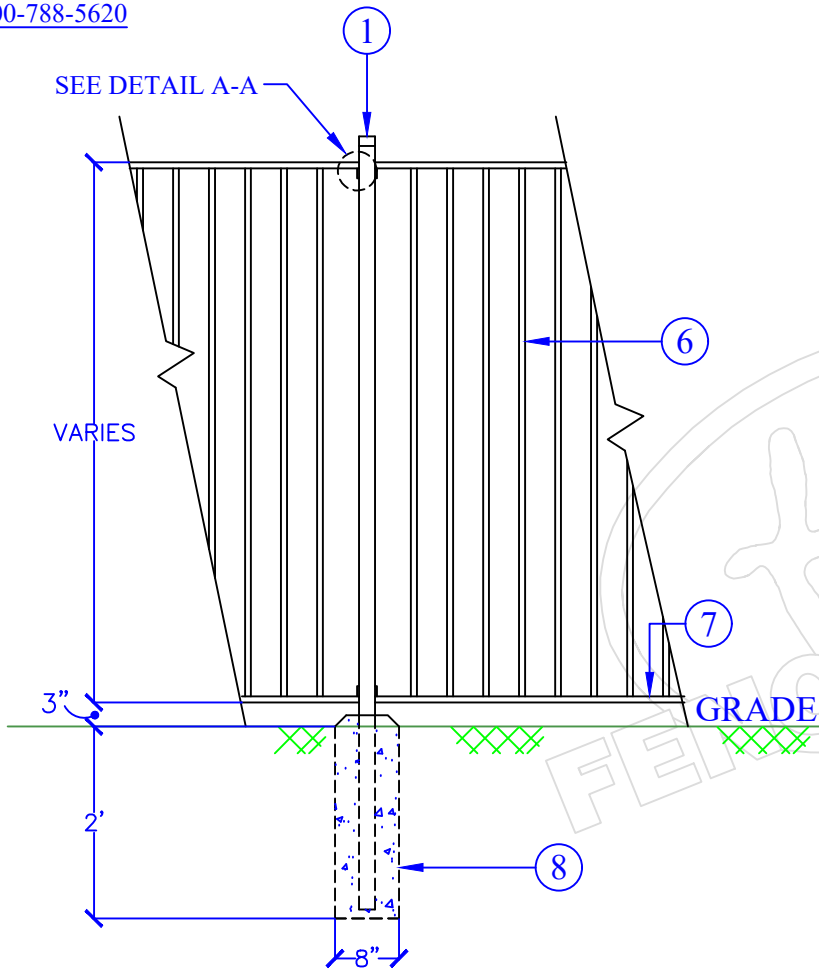

BRACKET ATTACHMENT DETAIL A-A

LEGEND

1. 2" SQ. TUBULAR STEEL POST W/ CAP @ 8'-0" O.C. (16 GA.)
2. 2" X 2" FENCE POST (OR BLOCK PORTION OF WALL/PILASTER.
3. OUTSIDE DIAMETER SLIGHTLY LESS THAN INSIDE DIAMETER OF TOP OR BOTTOM RAIL.
4. CAULK JOINT W/ CLEAR SILICON.
5. FENCE RAIL SLIPS OVER POST ASSEMBLY.
6. 5/8" SQ. PICKETS @ 4-1/2" O.C. (18 GA.)
7. 1-1/2" SQ. TUBULAR STEEL RAILS TOP & BOTTOM (16 GA).
8. 8" X 24" DOMED CONCRETE FOOTING.

NOTE:

- ALL MATERIAL TO BE PRE-GALVANIZED.
- PAINT WITH ONE COAT EPOXY PRIMER & ONE COAT POLYURETHANE FINISH COLOR BY OWNER.
- ALL PICKET CONTINUOUS WELDS AND COLD GALVANIZED APPLIED TO WELDS.
- CONNECT PANELS TO POST WITH SLIDER BRACKETS. (NO WELDING)

SCALE: NTS UNLESS NOTED	FW-CALIFORNIA TUBULAR STEEL FENCE		LOCATION: ANAHEIM RIVERSIDE FRESNO PALMDALE MANTECA SACRAMENTO BAKERSFIELD SANTA PAULA FALLBROOK	
DETAIL NO. 0/1-001				
LICENSE NO. 299964				